



BPX™ BPDW Double-Wall Brazed Plate Heat Exchangers

HIGH PERFORMANCE. REDEFINED.

C-320A

*Patent Pending

 **Bell & Gossett**
a xylem brand

BPX™ BPDW Double-Wall*

BPX™ BPDW Double-Wall brazed plate heat exchangers offer the highest level of leak protection, safety, thermal efficiency and durability in a compact, low cost unit. Bell & Gossett's advanced lean manufacturing process provides fast deliveries with maximum design flexibility.

BPX™ BPDW Double-Wall* Provides:

- True double-wall construction, including port regions
- Double-wall plate design with unique air vent leak paths
- Complete peripheral braze for additional strength
- Four dedicated leak ports for quick and easy leak detection (A)
- Excellent performance for domestic water applications
- Dependable protection of fresh water streams for cooling of oils and refrigerants.

Brazing Material

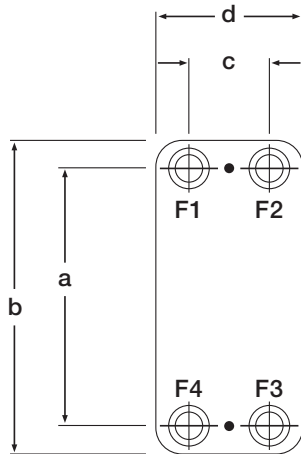
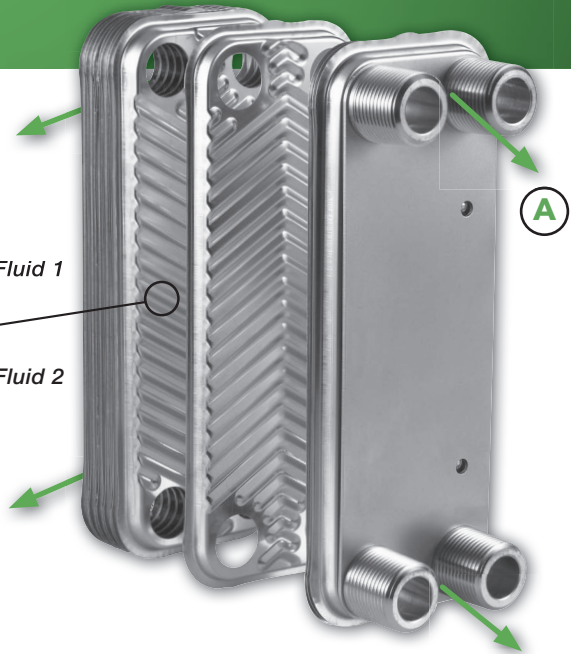
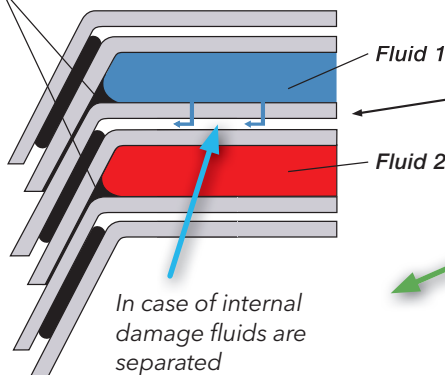

MODEL TYPE	A	B	C	D
BPDW410	9.84	12.2	1.97	4.4
BPDW415	18.35	20.7	1.97	4.4

Mechanical Design

Design Pressure (higher pressures available) 435 psig
 Maximum Design Temperature 450 F
 Minimum Design Temperature -310 F
 Plate Material 316L
 Braze Material Copper

Approvals & Certifications

- ASME Section VIII Div. 1 U-1 Stamp Available
- CRN, UL, CE/PED



Xylem Inc.
 8200 N. Austin Avenue
 Morton Grove, Illinois 60053
 Phone: (847) 966-3700
 Fax: (847) 965-8379
www.xylem.com/brands/bellgossett

Bell & Gossett is a trademark of Xylem Inc. or one of its subsidiaries.
 © 2011 Xylem Inc. C-320A May 2011 *Patent Pending